



# SPARROW-B-GONE!™

Send your house sparrows packing!

## Sparrow-B-Gone!™\* for BirdBuddy™\*

Model SBG-SBBR (fits BirdBuddy **without** the solar roof)

Thank you for purchasing Sparrow-B-Gone!™ - your house sparrows' worst nightmare!

These instructions are for BirdBuddy smart camera feeders **without a solar roof**, either bottom mounted or hanging. There is a different version of Sparrow-B-Gone that works with BirdBuddy feeders with a solar roof (Model SBG-SBBS). Contact us for a free return if you need the solar roof version.

Future Note: If you decide to add a solar roof to your BirdBuddy later, we have a conversion kit available in our Etsy store that will upgrade your product for use with your new solar roof (Model SBG-SBBU).

The two Sparrow-B-Gone products for BirdBuddy (regular roof or solar roof) are almost identical and are assembled and adjusted the same way. Please follow the assembly instructions for Sparrow-B-Gone for solar roofs that are included with this product but refer to the instructions below for more detailed images showing you how to install the Roof Mount Base on a BirdBuddy with regular roof.

### Install the Roof Mount Base

The roof mount base comes partially assembled, as shown below. On the bottom of the center part of the roof mount is a small clear rectangular adhesive with a protective cover, as shown in the second image below. Carefully remove the protective cover from the adhesive pad.

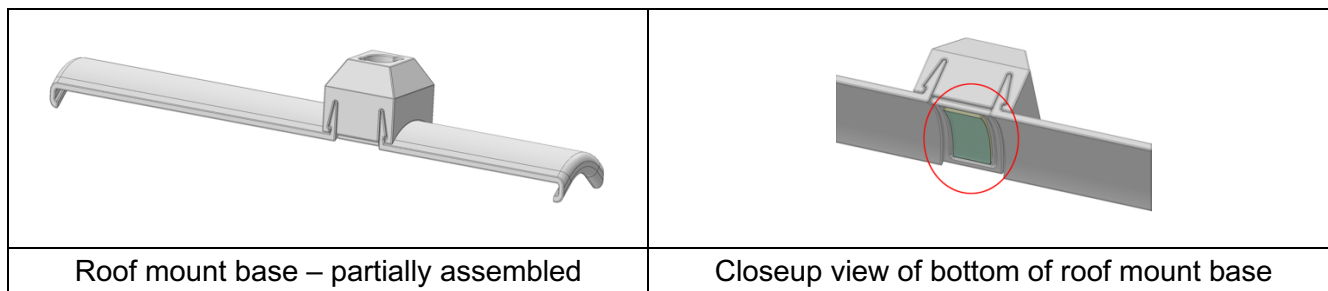

Note that there is a notch in the back of the regular roof. There is a matching projection on the inside of the back strap that aligns with this notch.

\* Sparrow-B-Gone! is a trademark of Synnovation LLC. BirdBuddy is a registered trademark of Bird Buddy Inc. Sparrow-B-Gone! is not an official add-on of any Bird Buddy Inc. product and Synnovation LLC is not in any way affiliated with, sponsored, or endorsed by Bird Buddy Inc.

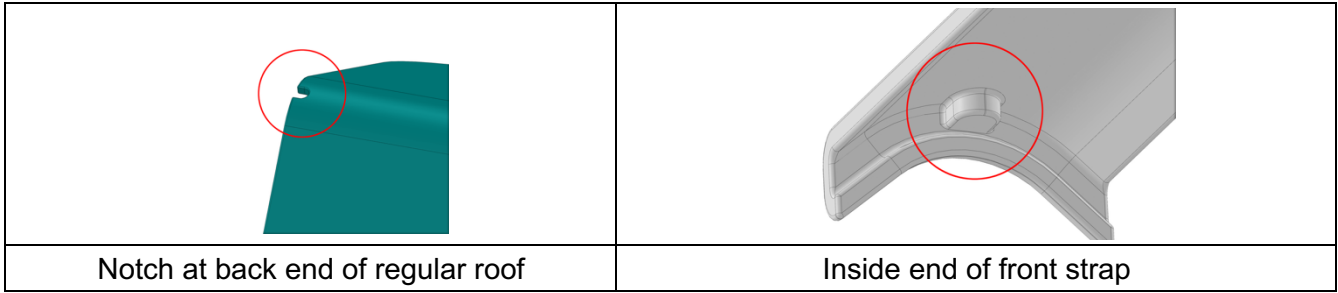

**IMPORTANT:** The roof mount base has a shorter front strap and a longer back strap. When you are ready to install the roof mount base, make sure that the shorter part of the roof mount base is at the front of the feeder. To install the roof mount base, make sure it is aligned correctly and then rotate the roof mount base until flush with the roof and the back part of the roof mount base has snapped into position. Push down the center part firmly to make sure that the adhesive pad is fully adhered to the roof of the BirdBuddy feeder

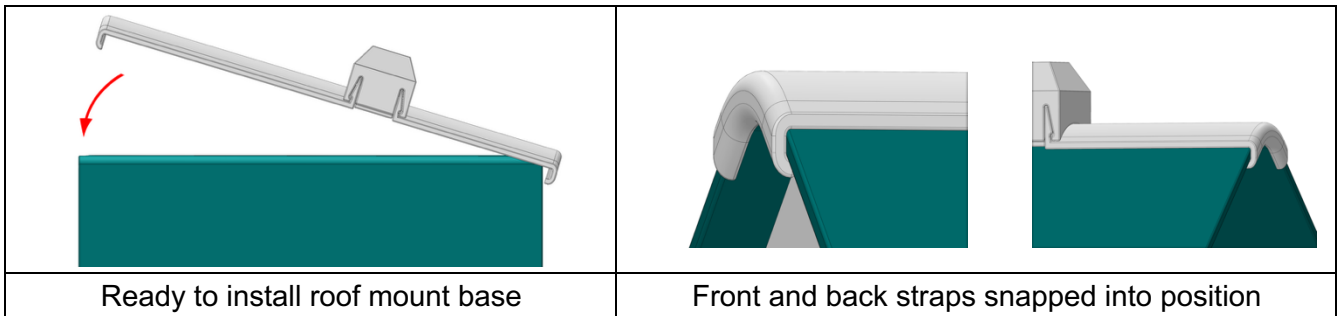

The final installation step is easy. Just snap the outer cover into place, as shown below.

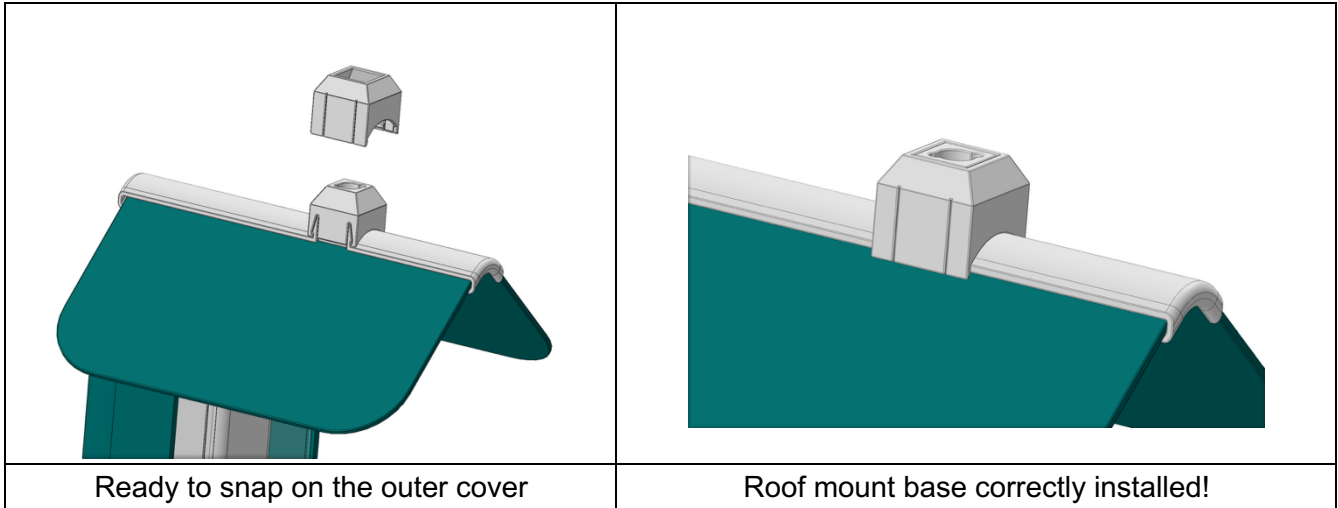

**Step 2: Attach Connecting Rod Assembly to Sparrow-B-Gone**

(Continue with instructions for the solar roof version).