



# SPARROW-B-GONE!™

*Send your house sparrows packing!*

## Sparrow-B-Gone!™\* for Birdfy 2™\*

### Model SBG-SFY2



Thank you for purchasing Sparrow-B-Gone!™ - your house sparrows' worst nightmare! Sparrow-B-Gone! Model SBG-SFY2 is specifically designed to work with any of the Birdfy Feeder 2 products. When fully installed, this is what a Birdfy 2 feeder with Sparrow-B-Gone! looks like:



### Parts List:

Sparrow-B-Gone!	Roof mount center and back straps	Roof mount front strap and cover

\* Sparrow-B-Gone! is a trademark of Synnovation LLC. Birdfy is a registered trademark of Netvue Inc. Sparrow-B-Gone! is not an official add-on of any Netvue Inc. product and Synnovation LLC is not in any way affiliated with, sponsored, or endorsed by Netvue Inc.

		
Connecting Rod	Top Cap	Screwdriver

**Step 1: Attach Sparrow-B-Gone Roof Mount Kit to your Birdfy 2 Feeder**

**We recommend that you bring the Birdfy 2 feeder inside to work on it.**

**Detach the roof from your Birdfy 2 feeder!**

It is much easier to install Sparrow-B-Gone on the roof of your Birdfy 2 feeder if it is separated from the body of the feeder. Fortunately, Birdfy designed the feeder so it is easy to remove the roof. You can easily detach the roof by: 1) unlatching the front of the roof as you normally do to add seed, 2) rotating the roof 90 degrees until it is pointing straight up like this:

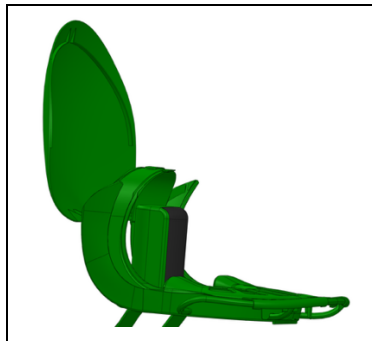

Once the roof is rotated like this, it can easily be removed by pulling the roof straight out from the body of the feeder. It is easiest to do if you pull the roof away from the body on one side first. After the Sparrow-B-Gone roof mount kit is installed, just reverse the process and push it in until clicks into place and rotates easily.

Sparrow-B-Gone for Birdfy 2 attaches to the top of the roof. The design consists of a roof mount system that is clamped to the top of the Birdfy roof, a connecting rod that can easily be inserted into or removed from the roof mount system, and a six-arm version of Sparrow-B-Gone that is connected to the top of the connecting rod.

Connecting the roof mount system to the roof of the Birdfy feeder is very easy. To install the roof mount kit, follow these simple steps:

1. There are five components of the roof mount system, as shown in the Parts List. We have partially pre-assembled the kit so that the two back straps are already connected to the center part.

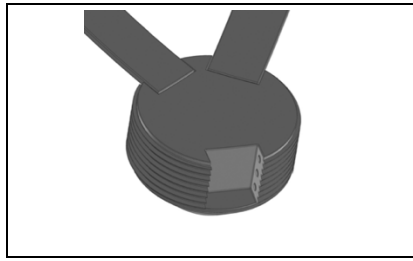

2. The second step is to position the center plus two straps onto the back of the Birdfy 2 roof. When positioned correctly, it will look like the first image below. If you look at the second picture, showing the underside of the roof, you will see that the ends of the two straps hug the edge of the roof and are positioned just outside the hinges on the back of the roof, as shown in the second picture below.

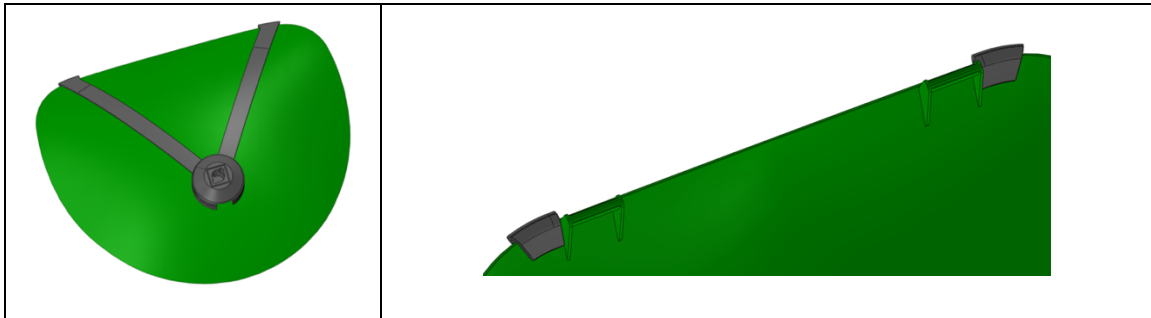

3. The next step is to snap the front strap into position. The first picture below shows the front underside of the roof with the front strap installed in the correct location. The other end of the front strap snaps into place at the front of the center piece with a little force. When snapped into place, it will look like the second picture below.

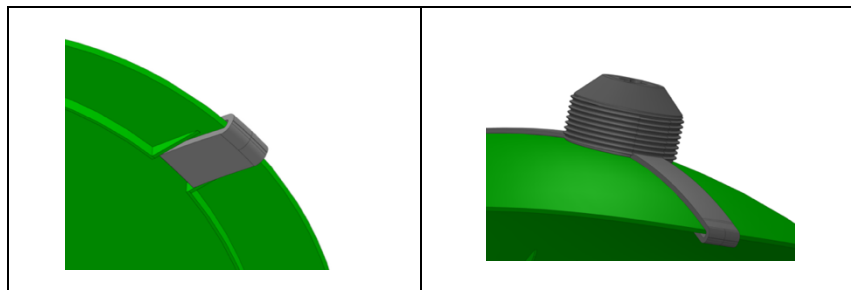

4. The last step in installing the roof mount kit is simple - just screw the top cap into place, as shown below.

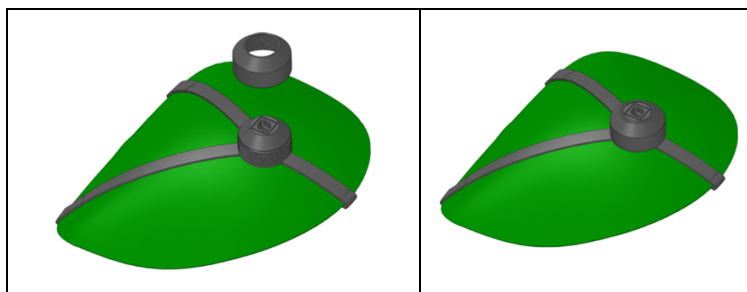

6. **Re-attach the roof.** The roof mount kit is fully installed, and you are ready to continue assembling Sparrow-B-Gone for Birdfy 2.

### **Step 2: Attaching Connecting Rod to Roof Mount Base**

To make it easy to fill and clean your Birdfy feeder, Sparrow-B-Gone use a simple socket-based connecting system that makes it very easy to connect or disconnect parts. Once the roof mount base is in place, the next step is attaching the connecting rod to the roof mount base. This is done by inserting the bottom of the connecting rod into the socket, rotating it 1/4 turn, and then pushing it down into place as shown in the left picture below. Separating the connecting rod from the roof mount base is done by reversing this process: pull the bottom of the connecting rod up slightly, rotate it 1/4 turn the other direction, and it easily will lift out of the roof mount base.

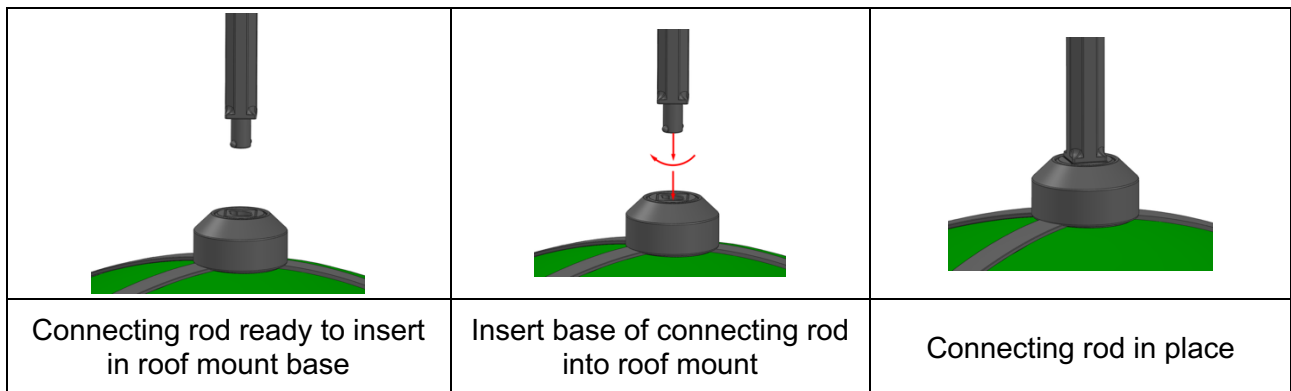

### **Step 3: Attaching Sparrow-B-Gone! to Connecting Rod**

Once the connecting rod is attached to the roof mount base, the next step is attaching the main part of the Sparrow-B-Gone product to the top of the connecting rod. This uses the same simple attachment system as is used to attach the connecting rod to the roof mount base, as is shown below. Start by rotating the four-arm top as shown in the first picture below. As you push it in, it will rotate 90 degrees and drop into place in the correct orientation, as shown in the second picture. The final step is to add the top cap to cover the socket on the top of the main Sparrow-B-Gone product using the exact same push-twist-push motion.

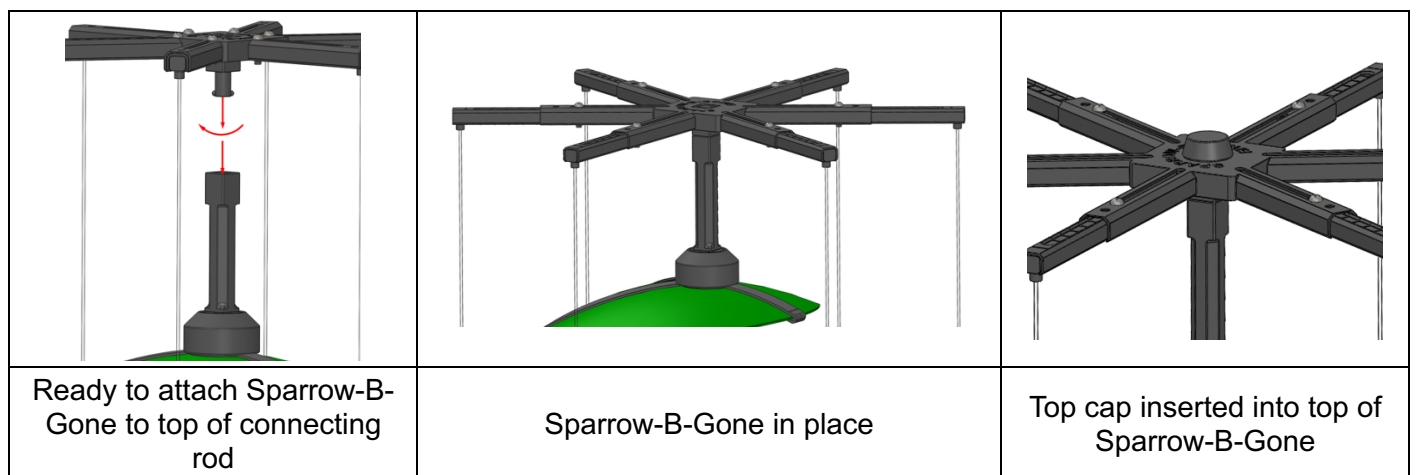

At this point, you might be wondering why there is a socket on top of the Rain-B-Gone product. We will soon be releasing a new product line called Katie Tops™ that are fun and colorful toppers that drop into the

top socket and are easily changed out for different ones. There will be Katie Tops with a seasonal focus as well as many cute birds and other animals. Check out our Etsy store ([sparrowbgone.etsy.com](https://sparrowbgone.etsy.com)) or our website ([Sparrow-B-Gone.com](https://Sparrow-B-Gone.com)) for further details.

## **Adjusting Sparrow-B-Gone**

### **Changing Arm Length**

Sparrow-B-Gone has two levels of arm length extension. You can add up to 2 ½” to the length of any arm by loosening the round head Phillips head screw and pulling the two inner arm sections together to the desired length. Tighten the round head screw fully when it is adjusted to the desired size.

If you want to extend the arms even more, start by fully extending the arms as indicated above. You will then see the head of the flat head screw used for the second stage adjustment through a small hole at the end of the outer arm. Loosen the flat head screw slightly until you can pull the inner arm out to the desired length. Then tighten the flat head screw when it is adjusted to the desired size.

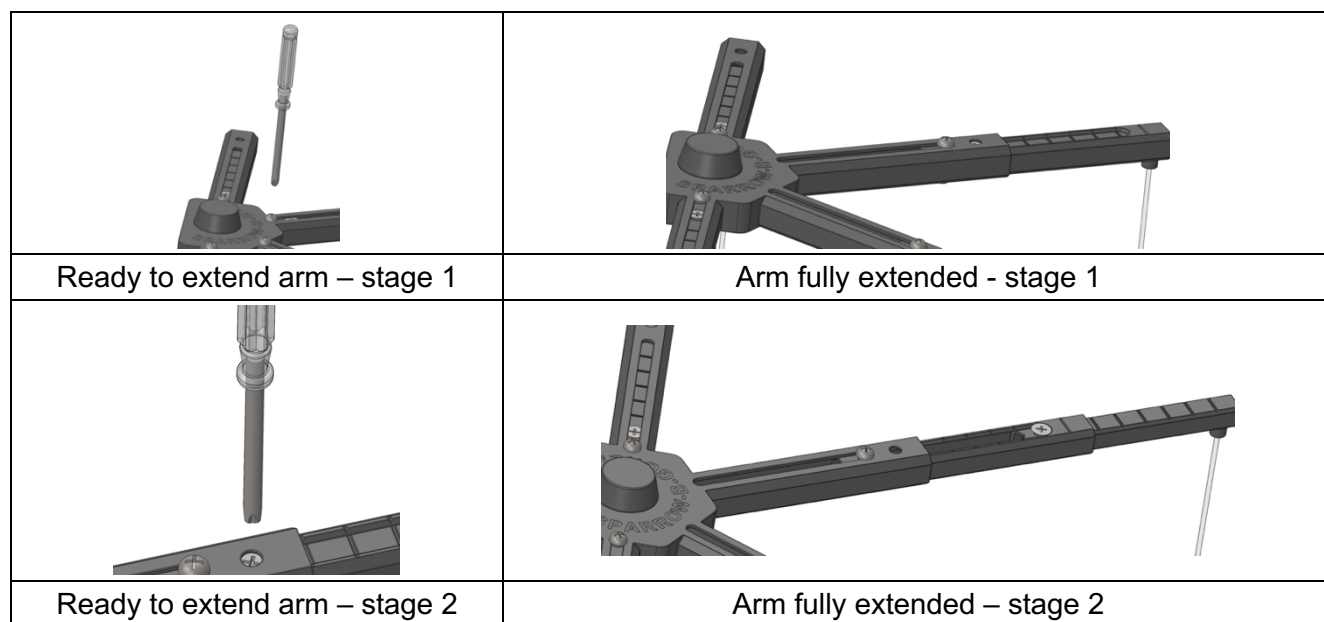

### **Adjusting cord length**

While the main product feature that scares away house sparrows is the reflective cords, it is likely that the reflective round ball weights might help as well. We generally recommend that the ball weights hang 2 to 3 inches below the bottom of the feeder or house. Adjusting the length of the cord is easy – just push or pull the cord where it comes out the bottom of the inner arm, as shown below. Note that initially, the end of the cord is above the cord lock. This makes it easy to move the cord in or out to adjust length. Once you are satisfied with the length, you should push the cord down into the cord lock and trim excess length with scissors. We recommend that you leave at least 1/2” of cord sticking out beyond the end of the cord lock.

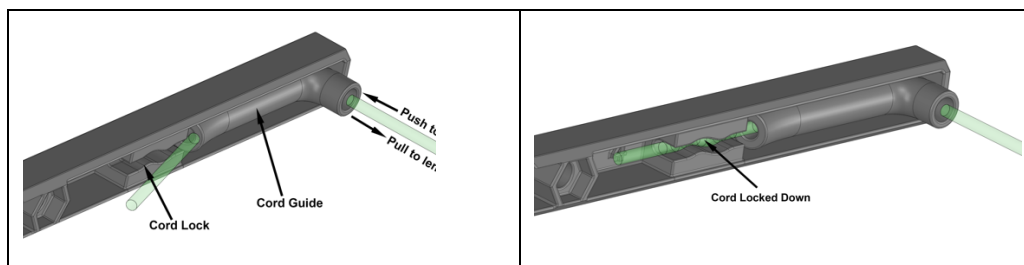

Note: initially the cords will be curved because of the way they are coiled in the package. The cords will gradually straighten out over a few days. It does take longer to straighten fully in cold weather, as you might expect.

Here are side and top views showing how Sparrow-B-Gone! for Birdfy 2 would typically be adjusted around the feeder:

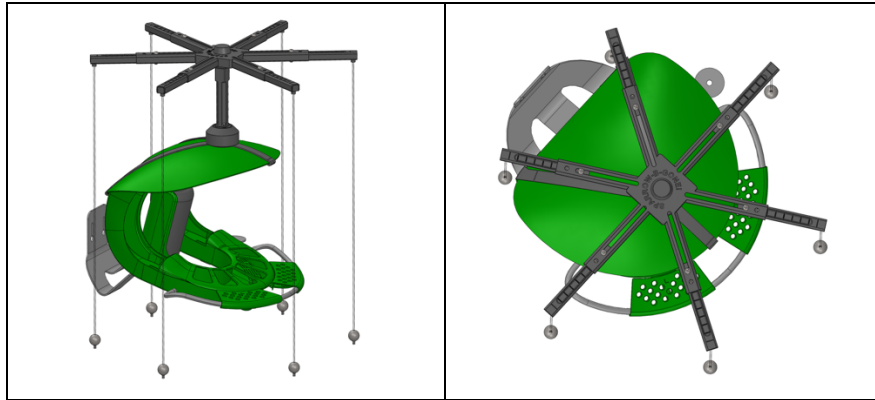

### **What Happens Next?**

As you probably know, when you first put out a new bird feeder, many birds are afraid of it. It can take up to two weeks for them to overcome their fear and start using the new feeder. The same thing may happen when you add Sparrow-B-Gone to an existing feeder. In our experience, and that of our customers, birds like gold finches, house finches, and chickadees have little or no fear of Sparrow-B-Gone and will return to the feeder quickly. Cardinals are a bit more cautious. We recommend giving it two full weeks to see how Sparrow-B-Gone will work for you. There is a 30-day return policy on the product for exactly this reason.

Also, research has shown that teenage house sparrows are not afraid of sparrow spookers like Sparrow-B-Gone! because, after all, they are teenagers! Fortunately, when they become adult house sparrows, they almost always come to their senses, think back and wonder “what was I thinking going near that scary object?” Overall, Sparrow-B-Gone should reduce your house sparrow problems by at least 90%.

**Enjoy!**

